







22-308

Release

1 February 2008

Subject

Status Report – Outstanding nominations to the Queensland Heritage Register

Background

- The *Queensland Heritage and Other Legislation Amendment Bill 2007* was passed by Parliament on Thursday 18 October 2007 with commencement to be fixed by proclamation.
- The Act is to be proclaimed on 31 March 2008.
- The amended Heritage Act introduces a new process for dealing with nominations which requires that all interested parties are notified of nominations when they are received and that nominations are processed within a timeframe of 140 business days (7 months).
- There are 2 points in the nomination process when the timeframe may be extended by 40 days which could increase the timeframe for an additional 80 days (4 months) in total.
- For applications to enter or remove a place from the register the transitional provision s.111 provides that for applications that have not been decided (e.g. either provisionally entered or not entered) then the application is taken to be an application made by the chief executive. These applications are taken to be received on the date of commencement which will be 31 March 2008.
- For applications to enter or remove a place from the register that have been made by the Heritage Council the transitional provision s.112 states that on commencement these applications are taken to have ended. This provision was considered necessary because Heritage Council nominations do not meet the new information requirements.

Issues

- The current number of outstanding nominations to the heritage register is 138 and 18 of these have been nominated by the Heritage Council.
- On commencement **120** of these nominations will be taken to be nominations under the amended Act and will have to be dealt with in 140 business days.
- The amended Act provides that if nominations are not decided in the time frame then they are deemed refused and cannot be re-nominated for 12 months.
- The EPA does not currently have sufficient resources to assess this number of places and efficiencies can be achieved by rolling some of the nominations into the state-wide survey.

Recommendations

1. The 48 nominated places that are within areas that will be covered by the State-wide Survey teams in the next 12 months be transferred to the State-wide survey. Due to the imminent changes to the Heritage Act this will

require a formal resolution from the QHC at its March 2008 meeting, deciding not to deal with these nominations at the present time and transferring them to the State-wide survey. The places will be re-nominated as part of the state-wide survey process.

2. The QHC resolve that the precinct nominations not be progressed in the current form and a formal resolution be presented to the QHC at its March 2008 meeting.
3. Places nominated by the Heritage Council will be re-nominated by the Chief Executive under the amended Act once research work has been undertaken to support the nomination. Where appropriate these nominations should also be transferred to the State-wide survey.
4. The Heritage Council note that if the above recommendations are adopted 61 outstanding nominations will fall within nomination timeframes on the commencement date of 31 March 2008.

Outstanding nominations	
Assessed under amended Act	61
Transfer to State-wide survey	48
QHC nominations	18
Precincts	6
March QHC	5
Total	138

Report prepared by:

Fiona Gardiner
Manager, Strategic Cultural Heritage Planning
Date: 9 January 2008

13 December 2002

Subject

RIVERSIDE CENTRE, EAGLE STREET, BRISBANE

(TBA)

Summary of Proposal

- Heritage Council is to consider on its own initiative to nominate the **Riverside Centre, Eagle Street, Brisbane**, to the Heritage Register under s.24 (1) of the *Queensland Heritage Act 1992*.

Date considered by Heritage Register Advisory Sub-committee: 05 December 2002

HRAC Recommendation:

That based on the oral report to the Heritage Register Advisory Committee, the **Riverside Centre, Eagle Street, Brisbane**, is a place of cultural heritage significance and meets one or more of the criteria under section 24 of the *Queensland Heritage Act 1992*, for entry in the Queensland Heritage Register.

Heritage Council Resolution

- Consider to nominate

Resolution 1

Having considered the oral report of the Agency for the **Riverside Centre, Eagle Street, Brisbane**, and the recommendation of the Heritage Register Advisory Committee for the **Riverside Centre, Eagle Street, Brisbane**, the Heritage Council resolves in accordance with Section 24(1) of the *Queensland Heritage Act 1992* to nominate the **Riverside Centre, Eagle Street, Brisbane** to the Heritage Register.

OR

- Not to nominate

Resolution 1

Having considered the oral report of the Agency for the **Riverside Centre, Eagle Street, Brisbane**, and the recommendation of the Heritage Register Advisory Committee for the **Riverside Centre, Eagle Street, Brisbane**, the Heritage Council resolves in accordance with Section 24(1) of the *Queensland Heritage Act 1992* **not** to nominate the **Riverside Centre, Eagle Street, Brisbane** to the Heritage Register.

Officer reporting

Joanne Ketter

Queensland Heritage Council Secretariat

06 December 2002

14 March 2008

Subject

Status Report – Outstanding nominations to the Queensland Heritage Register

Background

- The *Queensland Heritage and Other Legislation Amendment Bill 2007* was passed by Parliament in October 2007 and will commence on 31 March 2008.
- The amended Heritage Act introduces a new process for dealing with nominations which requires that all interested parties are notified of nominations when they are received and that nominations are processed within a timeframe of 140 business days (7 months).
- For applications to enter or remove a place from the register the transitional provision s.111 provides that for applications that have not been decided (e.g. either provisionally entered or not entered) then the application is taken to be an application made by the chief executive. These applications are taken to be received on the date of commencement which will be 31 March 2008.
- For applications to enter or remove a place from the register that have been made by the Heritage Council the transitional provision s.112 states that on commencement these applications are taken to have ended. This provision was considered necessary because Heritage Council nominations do not meet the new information requirements.
- A strategy to deal with the outstanding nominations was put to the Heritage Council at its meeting on 1 February 2008.
- In essence the strategy was to move a number of nominations into the State-wide survey and to deal with the remaining places as a backlog project. The places to be moved into the State-wide survey are dealt with in item 6.5.
- EPA staff in central office will work on the backlog project for 4 to 5 months and this will mean ceasing work on the State-wide survey. Where possible contractors will be also be used to do backlog nominations.
- Heritage Council approved this strategy at its meeting on 1 February 2008 (resolution 213.4).
- There have been further nominations in January 2008.

Outstanding nominations	1/02/2008	4/03/2008
Assessed under amended Act	61	64
Transfer to State-wide survey	48	51
QHC nominations (renominate)	18	12
Precincts	6	
March QHC	5	13
Nominator to withdraw		1
Total	138	141

Report prepared by:

Fiona Gardiner
Manager, Strategic Cultural Heritage Planning
Date: 5 March 2008

14 March 2008

Subject

Nominations recommended to be transferred to the State-wide Survey

Background

- The *Queensland Heritage and Other Legislation Amendment Bill 2007* will commence on 31 March 2008.
- Under the transitional provisions all outstanding nominations will be taken to be nominations received on 31 March 2008.
- There are currently 142 outstanding nominations.
- A strategy to deal with the outstanding nominations was put to the Heritage Council at its meeting on 1 February 2008.
- The Heritage Council agreed that 142 nominations could not be handled concurrently and that some nominations could be transferred to the State-wide survey.
- The proposal is for 51 places that have been nominated to be considered as part of the State-wide survey.
- These 51 places are in regions where a survey is currently underway.
- A backlog mining places project will also be undertaken.
- The mechanics of the proposal are that the places would be renominated when the surveys are completed.
- The list of nominated places grouped according to survey region are:

Mining project	
602645	s.73 Irrelevant information
601866	
601850	
601865	
601212	
601465	
601854	
602372	
601877	
601036	
602358	
602496	
602606	
Central region Survey	
601932	s.73 Irrelevant information
602366	
602451	
602546	
602593	
602609	
602618	
602666	

Far Northern Survey	
601128	s.73 Irrelevant information
601146	
601483	
601542	
601691	
602499	
602535	
602558	
602576	
602577	
602587	
602590	
602595	
602600	
602604	
602614	
602643	
602653	
602657	
Wide Bay Burnett Survey	
602395	s.73 Irrelevant information
602249	
602597	
602647	
602655	
602656	
602640	
North Coast/ Seaside Accommodation	
602425	s.73 Irrelevant information
World War 2 North Queensland	
602625	s.73 Irrelevant information
602641	
Brisbane survey	
602457	s.73 Irrelevant information

Heritage Council Resolution

Resolution

Having considered the report of the Agency for the 52 places on the attached list, the Heritage Council resolves in accordance with s.35(4) of the *Queensland Heritage Act 1992* not to enter, these places provisionally in the Heritage Register.

Although these places may be places of cultural heritage significance and may satisfy one or more of the criteria specified in s.34(1) of the Act, the Heritage Council resolves that it is more appropriate for these places to be considered in the context of the State-wide cultural heritage survey.

Report prepared by:

Fiona Gardiner
 Manager, Strategic Cultural Heritage Planning
 Date: 5 March 2008

OUTSTANDING NOMINATIONS TO QUEENSLAND HERITAGE REGISTER 9 JANUARY 2008

PLACE_REF	PLACE_NAME	LGA	Current Status	Region	Nominating Organisation	Date
601170	s.73 Irrelevant information					
601205						
601250						
601317						
601477						
601480						
601637						
601765						
601767						
601775						
601777						
601929						
602010						
602075						
602102						
602127						
602156						
602174						
602183						
602188						
602322						
602339						
602370						
602372						
602381						
602394						
602399						
602407						
602428						
602430						
602434						
602436						
602534						
602544						
602553						
602554						
602555						
602562						
602569						
602571						
602575						
602578						
602579						
602580						
602581						
602582						
602585						
602591						
602607						
602620						
602626						
602627						
602630						
602633						

Published on DES Disclosure Log
RTI Act 2009

PLACE REF	PLACE NAME	LGA	Current Status	Region	Nominating Organisation	Date
602635	s.73 Irrelevant information					
602636						
602637						
602650						
602652						
602660						
602664						

Transferred to State-wide surveys currently in progress

601340	s.73 Irrelevant information					
601932						
602366						
602451						
602546						
602593						
602609						
602618						
602666						
602418						
601128						
601146						
601483						
601542						
601691						
602499						
602535						
602558						
602576						
602577						
602587						
602590						
602595						
602600						
602604						
602614						
602639						
602643						
602653						
602657						
602395						
602425						
602249						
602597						
602647						
602655						
602656						
602625						
602641						
602661						
601036						
602358						
602496						
602606						
602640						
602645						
602448						

PLACE REF	PLACE NAME	LGA	Current Status	Region	Nominating Organisation	Date
602457	s.73 Irrelevant information					
QHC nominations						
601268	s.73 Irrelevant information					
601212						
601465						
601854						
601877						
602238						
602239						
602247						
602316						
602401	Riverside Centre	BRISBANE CITY COUNCIL	Nominated	Southern Region	Queensland Heritage Council	13/12/2002
602420	s.73 Irrelevant information					
602620						
602621						
602646						
602649						
601866						
601850						
601865						
Precincts						
601930	s.73 Irrelevant information					
602132						
602347						
602469						
602592						
602616						
March QHC						
601286	s.73 Irrelevant information					
601751						
602386						
602416						
602550						
Total outstanding nominations to QHR						
Assessed under ammended Act			61			
Transfer to State-wide survey			48			
QHC nominations (renominate)			18			
Precincts			6			
March QHC			5			
Total			138			

SQL Statement
SELECT DISTINCT places_detail.site_id, places_detail.place_ref, places_detail.place_name, places_detail.lga, places_detail.reg_status "Current Status", places_detail.epa_region "Region", Nomination_detail.nominator_org_name "Nominating Organisation" FROM chimsown.places_detail, chimsown.nomination_detail WHERE (places_detail.site_id = nomination_detail.site_id) AND (places_detail.reg_status = "Nominated")--AND (nomination_detail.nominator_org_name = "Queensland Heritage Council")

Published on DES Disclosure Log
RTI Act 2009

FIRST DRAFT ONLY

Name	Riverside Centre
Former/Other Name	
Location	123 Eagle Street, Brisbane
RPD	Lot 30 RP 204762 Par North Brisbane Co Stanley
Local Authority	Brisbane City Council
AMG Map Sheet	Grid
Present tenure	GPT Management Ltd
Listing boundary	Whole of property

Other listings

Cultural Heritage Significance

The Riverside Centre is a place of cultural heritage significance and satisfies one or more of the criteria specified in s.23 (1) of the Act as evidenced, but not exclusively, by the following statement of heritage significance based on criteria a, d, e and h: ????

The Riverside Centre is important in demonstrating the evolution and pattern of the development of commercial building in Brisbane. An example of the way in which the maritime buildings of the previous century (warehouses, insurance and shipping agents, wharf buildings etc) were replaced by office towers following the relocation of the port and changes in commerce. It was the tallest building in Queensland by five storeys when first erected. It was the first (?) of the late 20th century high-rise buildings in the Brisbane CBD to embrace the presence of the river in its design? NOT THE FIRST, BUT PROBABLY THE MOST INFLUENTIAL OF THE MODERN DESIGNS. DON SAYS IT IS A VERY SOPHISTICATED BUILDING COMPARED TO WHAT CAME BEFORE.

It might be said to be a good example of a high-rise building of its era and demonstrates both Seidler's approach to towers ie a very large footprint which opens the site, and also from a construction point of view as it uses a high level of repetition to gain economies of time and materials.

Though the building appears to be an accomplished example of Seidler's work rather than an innovative design, it has been generally admired and won several architectural prizes. A landmark building on the river bank.

The Riverside Centre is important as an example of the commercial work of Harry Seidler, an important 20th century architect in Australia. (The only one until recently – Riparian Plaza is now under construction)

History

The Riverside Centre is a 40-storey office tower in the Brisbane central business district and was constructed between 1983-1986 for General Property Trust through Lend Lease Development to the design of Australian-based architect Harry Seidler.

The first 'skyscraper' in Brisbane was Ascot Chambers, built in 1924-25 to the height limit then imposed by the Brisbane City Council. It was the tallest building in Queensland at the time and excited considerable public interest.

In the Interwar period the skyline of Brisbane CBD altered as more multi-storey commercial buildings were constructed and photographs taken looking along Queen Street in the late 1930s show an almost continuous series of high-rise buildings on each side of the street.

In 1965 a new town plan triggered considerable redevelopment in the Brisbane CBD. The first major modern high-rise in Brisbane was probably the SGIO building, said to be the first to top 100 metres and which was completed in 1970, *The height of this building varies in different accounts - 24 stories according to a contemporary account and 30 according to an international architectural web site - which ?*

In 1974 the Brisbane City Council Sesquicentenary souvenir remarked that the 'massive construction of high-rise office blocks gives an indication of the development currently occurring in Brisbane'. It was an era when progress was notoriously measured by cranes on the Brisbane skyline and conservation groups fought to preserve 19th century buildings occupying prime sites.

The first landmark high-rise building to be constructed near the river in Eagle Street was the 1976 AMP Place, which featured a golden glass curtain wall and was the first such building in Queensland. It was the tallest building in the state at 35 storeys. Between 1970 and 1990 over 20 major high-rise buildings were constructed in the Brisbane CBD (23 floors and over).

Harry Seidler designed the Riverside Centre in 1983. It replaced a number of nineteenth century warehouses and offices including Luya Julius, Sun Alliance, Scottish Union, Chiropractic House and associated wharves and buildings. *(These were recognised by the National Trust and by Brisbane City Council as having heritage significance)*

The Riverside Centre tower was designed as part of a phased project comprising a triangular tower of 40 storeys, a lower tower of cylindrical shape and an apartment block of undulating form along the riverbank. The triangular tower was built first but the later phases of the project did not proceed. The shape of the Riverside tower allowed a maximum number of windows to overlook the river and a large plaza that extended right to the waterfront surrounded the new tower. Ferry wharves were planned as well as underground car parking.

Harry Seidler was born in Austria in 1923. In 1938 he moved to Britain and attended the Cambridge Technical College, then in 1941 he went to Canada where he studied for a degree in architecture. He then studied with leading figures of the modern movement such as Walter Gropius and Marcel Breuer at the Harvard School of Design and with Joseph Albers in North Carolina. He also worked with Breuer in New York and briefly with Oscar Niemeyer in Rio de Janeiro. He arrived in Australia, where his parents had settled, in 1948. His works in Australia include a house for his parents in 1948, Blues Point Tower, Sydney (1962), Australia Square,

Sydney (1967), Edmund Barton Offices, Canberra (1974) (which are on the Australian Heritage Places Inventory together with the Rose Seidler house and the Myilly Terrace house in Darwin). He also designed the MLC Centre, Sydney (1978) and Grosvenor Place, Sydney (1988). Overseas, Seidler designed the Australian Embassy in Paris (1977), The Hong Kong Club (1983), and a mixed-use housing scheme in Vienna. Currently another major Seidler project, the 53 level Riparian Plaza, is being constructed close to the Riverside Centre.

It was said by the jury of the Sir Zelman Cowan Award that *'it was not that Harry Seidler had done anything radically new with his own already well honed skills but that the scale and size the project allowed its very simple clean cut design approach to make an impact by its repetition over a large area and a number of small buildings at concourse level.'*

Perhaps it can be said to *'clearly illustrate the architectural principles on which his design are based' as with the Edmund Barton Offices?* It does provide considerable open space at the foot of the tower, which seems to be a feature of his buildings. (Note that Riverside is not listed with 'notable works in Australia' on the Seidler biographical site.)

Riverside Towers was possibly the first of the late 20th century buildings in this part of the Brisbane CBD to respond architecturally to the presence of the river, as the Customs House did a hundred years earlier. The AMP tower is almost as close to the water as the Riverside Centre and has similar river views from its upper levels, but is boxed in by three streets on its triangular site. Riverside Centre allows public access to the riverbank.

Riverside was completed in 1986 and won the Sir Zelman Cowan Award for Public Buildings in 1987. The jury decided that it could be considered for this award, though it was a commercial building, because of the public use of its surrounding plaza. Craft markets begun by local restaurateur, Peter Hackworth, have since become a major attraction in Brisbane.

The Jury's report for this award praised its... *unique relationship to the Brisbane River... in this case, the river is not only part of the building, but a focal point. Plaza areas link the building to the waterfront. Waterfalls provide a visual link with the water's edge. Ferries, Yachts and pleasure craft tie up at the piers, watched by people at the open-air plaza restaurants.*

Riverside Centre also won the Marble Architectural Awards (Carrara Italy) in 1989 (for the use of stone in a building – is there any marble in it?) and the RAI (Queensland) Robin Dods Triennial Medal in 1989.

Changes to the tower building since completion appear to be minimal. There are some changes of tenancies in the plaza buildings, but the type of tenants – eg restaurants, bars and services such as a pharmacy appear to be similar. The recent Pig and Whistle tenancy, apart from some signage, appears to be largely a refit and has had minor visible effect on the plaza.

Questions

Of Lawrie at BCC –

Did it have an effect on the kind of plans later submitted for riverfront development? Do they think it may have triggered a new interest in the river, or was it a response to this? BCC river initiatives?

Of Seidler –

Where does it sit in his oeuvre?

The design concept – effect on design of not proceeding with stages originally planned? Were any modifications made because of this? Does he think this affected the way in which the building addresses the river etc.

Is it a d? – to what extent and in what ways can it be considered ‘typical’ of his work?

How important to the design does he feel the foyer sculpture is? Did he work with the artist or choose the design? Should it be included in the listing? Can I have some info on the artist? What about landscaping, the tree etc. What does he feel should be included in the listing? (it may be necessary for practical reasons to exclude tenancies – at least in the tower, or at least internal work as it is subject to continual change)

How innovative were construction methods with respect to Brisbane? Where there any construction problems which may have been associated with this?

Of Stewart -

The heritage agreement may address tenancies in the plaza where they have high visibility – guidelines for signage and external work for instance. Amendments to the Act may make it possible to exclude types of work such as tenancy re-fits in the tower – things like carpet, partitions, decorative schemes are normally easily reversible anyway. Is there a paper or guidelines on the form and wording on heritage agreements, or on the amendments to the Act?

Description

Write from published work, preferably Seidler’s . Get Don to check all points covered and terms correct. I have info on the plaza tenancies etc. now.

Process:

Pursuant to the provisions of the Queensland Heritage Act 1992, the Heritage Council has formed the opinion that this is a place of cultural significance which satisfies one or more of the criteria for provisional entry in the Heritage Register and that it is possible for the cultural heritage significance of the place to be conserved.

The decision of the Heritage Council is recorded in the minutes of the Council meeting of *****.

Note: This document has been prepared on the basis of current information, and assessed under the criteria in the Queensland Heritage Act. This document may be reassessed if further evidence becomes available. The statement of significance specifies the most important heritage values of the place. The purpose of this document is to provide an informed evaluation for heritage registration. This does not negate the need for a thorough conservation study by a qualified practitioner, or Cultural Heritage Branch consultation, before any action is taken which may affect the significance of the place.

**Environmental Protection Agency
Emerging Issue Briefing Note**

Noted/Approved/Not Approved
Date / /

Briefing Officer: Maureen Lillie
Telephone: (07) 3225 1046
Correspondence. No:
File No: 602401

17 February 2003

To: Director-General
Subject: Riverside Centre

Recommendation

- The Director-General note that, because of misleading information in Heritage Council minutes and the media, EPA has been asked to supply documents under FOI that don't exist; and
- EPA officers may be required to appear as witnesses in a court case connected with the Riverside Centre.

Director General's Comments

Background

- On 13 December 2002, the Queensland Heritage Council (QHC) **itself** nominated the Riverside Centre for entry on the Queensland Heritage Register and requested that its assessment by Environmental Protection Agency (EPA) officers be a priority.
- No information other than a 1988 photographic study was tabled at the meeting, although the minutes (142.6.2.1) state that a report was prepared by the EPA for the meeting. QHC Secretariat advised (31.01.02) that 'the minutes overstate what was tabled'.
- A preliminary draft for the register has been prepared subsequently for consideration by the Heritage Register Advisory Committee (HRAC) and is likely to be scheduled for its March meeting.
- EPA planning officers' recommendation will be:
 - To limit any entry to the exterior and public spaces within and without the building; and

- That a group of landmark buildings in Brisbane be reviewed as possible exemplars for assessment of future nominations to the Heritage Register and the Riverside Centre be considered in this context i.e. consideration of the entry be deferred.

Key Issues

- The architect of the Riverside Centre, Harry Seidler, is suing the tenants of the Pig 'n' Whistle tenancy under the *Copyright Amendment (Moral Rights) Act 2000*. Because of the nomination, the EPA may be asked/subpoenaed for an opinion on the building's significance.
- The nomination was made by the QHC itself with no supporting information and was announced to the media prior to discussion by the QHC. The newspaper article stated that the building had been the subject of several years' research by the EPA, which is not the case. EPA files have been subject to an FOI request by legal firm Freehills.
- Because of the large number of tenancies in a high-rise building such as this, and because of the novel nature of the nomination, it is likely that it will be contested and media interest will be high.

Supporting:

File note of meeting/discussion

Meeting

Date: 15 April 2003 Time: 10.30 am

Between Robyn Hesse and Maureen Lillie of Southern Region Planning

And representatives of Riverside Centre – [sch4p4(6) Personal information] GPT) and

[sch4p4(6) Personal info] (Freehills)

Subject: **Riverside Centre**

They are interested in working with EPA on the preparation of the entry and on a heritage agreement. Excluding the tenancy fitouts from the entry would relieve their first major problem. The second is whether or not approved development to buildings on adjoining sites will cause problems (eg Black Ink tower and the new Riparian Plaza).

They already have an agreement with BCC regarding 'light and air easements' and views from the Riverside tower and will provide copies of these for EPA files.

Riverside management are happy to provide information needed and I am to ring the building manager and arrange a date to inspect the building and take photographs. They will arrange for me to meet the architect, Harry Seidler, when he is next on a site visit to Riparian Plaza, in order to talk to him about Riverside and its possible significance.

Maureen Lillie

30/4/2003 inspection carried out with Peta Dennis.

7/5/2003 copies of digital photos provided to [sch4p4(6) Pers] of Riverside for their records. by prior arrangement.

20/5/2003 received copies of easement documents from Freehills.

12/6/2003 Call from [sch4p4(6) Person] e setting up a meeting to discuss the heritage agreement. They also wish to talk to someone about excluded work, application etc to they understand the process. He will talk to his Sydney office and get tentative dates.

File note of meeting/discussion

Meeting Telephone
Date: 12 June 2003 Time: 10.45
Between sch4p4(6) Personal of Riverside
And Maureen Lillie of EPA
Subject: Riverside Centre

He wants to set up a meeting to discuss a heritage agreement. Stewart has provided me with a draft of his guidelines for heritage agreements that he said could be shown to them, emphasising that it is a draft.

sch4p4(6) also is arranging a meeting, though his Sydney office, with architect Harry Seidler. This should be within two weeks and he will get back to me with a suitable date.

Can they also talk to someone about excluded work, development applications etc so that they understand the process? (Peta is happy to do this).

Maureen Lillie

RIVERSIDE CENTRE

The Riverside Centre was constructed between 1983-1986 for General Property Trust through Lend Lease Development to the design of architect Harry Seidler.

The first 'skyscraper' in Brisbane was Ascot Chambers, built in 1924-25 to the height limit then imposed by the Brisbane City Council. It was the tallest building in Queensland at the time and excited considerable public interest.

In the Interwar period the skyline of Brisbane CBD altered as more multi-storey commercial buildings were constructed and photographs taken looking along Queen Street in the late 1930s show an almost continuous series of high-rise buildings on each side of the street.

In 1965 a new town plan triggered considerable redevelopment in the Brisbane CBD. The first major modern high-rise in Brisbane was probably the SGIO building, said to be the first to top 100 metres and which was completed in 1970. In 1974 the Brisbane City Council Sesquicentenary souvenir remarked that the 'massive construction of high-rise office blocks gives an indication of the development currently occurring in Brisbane'. It was an era when progress was notoriously measured by cranes on the Brisbane skyline and conservation groups fought to preserve 19th century buildings occupying prime sites.

The first landmark high-rise building to be constructed near the river in Eagle Street was the 1976 AMP Place, which featured a golden glass curtain wall and was the first such building in Queensland. It was the tallest building in the state at 35 storeys. Between 1970 and 1990 over 20 major high-rise buildings were constructed in the Brisbane CBD (23 floors and over).

Harry Seidler designed the Riverside Centre in 1983. It replaced a number of nineteenth century warehouses and offices including Luya Julius, Sun Alliance, Scottish Union, Chiropractic House and associated wharves and buildings. *(These were recognised by the National Trust and by Brisbane City Council as having heritage significance)*

The Riverside Centre tower was designed as part of a phased project comprising a triangular tower of 40 storeys, a lower tower of cylindrical shape and an apartment block of undulating form along the riverbank. The triangular tower was built first but the later phases of the project did not proceed. The shape of the Riverside tower allowed a maximum number of windows to overlook the river and a large plaza that extended right to the waterfront surrounded the new tower. Ferry wharves were planned as well as underground car parking.

Harry Seidler was born in Austria in 1923. In 1938 he moved to Britain and attended the Cambridge Technical College, then in 1941 moved to Canada where he worked to gain a degree in architecture. He studied with leading figures of the modern movement such as Walter Gropius and Marcel Breuer at the Harvard School of Design and with Joseph Albers in North Carolina. He also worked with Breuer in New York and briefly with Oscar Niemeyer in Rio de Janeiro. He arrived in Australia, where his parents had settled, in 1948. His works in Australia include a 1948 house for his parent, Blues Point Tower, Sydney (1962), Australia Square, Sydney (1967), Edmund Barton Offices, Canberra (1974) (which are on the Australian Heritage Places Inventory together with the Rose Seidler house and the Myilly Terrace house in Darwin). He also designed the MLC Centre, Sydney (1978) and Grosvenor Place, Sydney (1988). Overseas, Seidler designed the Australian Embassy in Paris (1977), The Hong Kong Club (1983), and a mixed-use housing scheme in Vienna. Currently another major Seidler project, the 53 level Riparian Plaza, is being constructed close to the Riverside Centre.

Riverside Towers was possibly the first of the late 20th century buildings in this part of the Brisbane CBD to respond architecturally to the presence of the river, as the Customs House did a hundred years earlier. The AMP tower is almost as close to the water as the Riverside Centre and has similar river views from its upper levels, but is boxed in by three streets on its triangular site. Riverside Centre allows public access to the riverbank.

Perhaps it may be said to '*clearly illustrate the architectural principles on which his design are based*' as with the *Edmund Barton Offices*? It provides considerable open space at the foot of the tower, which seems to be a feature of his buildings. (Note that Riverside is not listed with 'notable works in Australia' on the Seidler biographical site.)

Riverside was completed in 1986 and won the Sir Zelman Cowan Award for Public Buildings in 1987. The jury decided that it could be considered for this award, though it was a commercial building, because of the public use of its surrounding plaza. Craft markets begun by local restaurateur, Peter Hackworth, have since become a major attraction in Brisbane.

The building won the Selman Cowan Award, The jury said that '*it was not that Harry Seidler had done anything radically new with his own already well honed skills but that the scale and size the project allowed its very simple clean cut design approach to make an impact by its repetition over a large area and a number of small buildings at concourse level.*' The award citation also praised its ... '*unique relationship to the Brisbane River...in this case, the river is not only part of the building, but a focal point. Plaza areas link the building to the waterfront. Waterfalls provide a visual link with the water's edge. Ferries, Yachts and pleasure craft tie up at the piers, watched by people at the open-air plaza restaurants.*'

Riverside Centre also won the Marble Architectural Awards (Carrara Italy) in 1989 (for the use of stone in a building) and the RAI (Queensland) Robin Dods Triennial Medal in 1989.

Changes to the tower building since completion appear to be minimal. There are some changes of tenancies in the plaza buildings, but the type of tenants – eg restaurants, bars and services such as a pharmacy appear to be similar. The recent Pig and Whistle tenancy, apart from some signage, appears to be largely a refit and has had minor visible effect on the plaza.

**Report to
Heritage Register Advisory Committee**

Agenda no. ...

13 February 2003-02-03

Subject

**Riverside Centre, Eagle Street, Brisbane
602401**

Summary of Proposal

- HRAC is to give direction regarding the progress of the nomination to the Queensland Heritage Register of the **Riverside Centre, Eagle Street, Brisbane** made by the Heritage Council.

Background and Issues

- The Heritage Council nominated this place for entry on the Queensland Heritage Register with a request for priority status. No information other than a 1988 monograph comprising photographs and an essay in praise of the original design concept was tabled and no other information was held by the Agency.
- Considerable research has since been carried out and a report in the form of a preliminary draft entry to the Heritage Register has been prepared and is attached.
- As this is highly likely to be a contentious listing, the opinion of the Heritage Register Advisory Committee is sought on possible significance and whether or not outside expertise should be sought on this matter.
- It is believed that the architect of the Riverside Centre is currently suing the tenants of the Pig and Whistle tenancy under recent amendments to the Australian Copyright Act that protect the right of integrity of authorship of artistic creations. Staff architect, Peta Dennis, and I recently visited the site to make a note of changes, including those carried out in the Pig and Whistle re-fit.

Attached

- First draft of entry showing research to date
- Plans and photographs (book with colour photographs and plans will be tabled)

Officer reporting

Maureen Lillie
3 February 2003



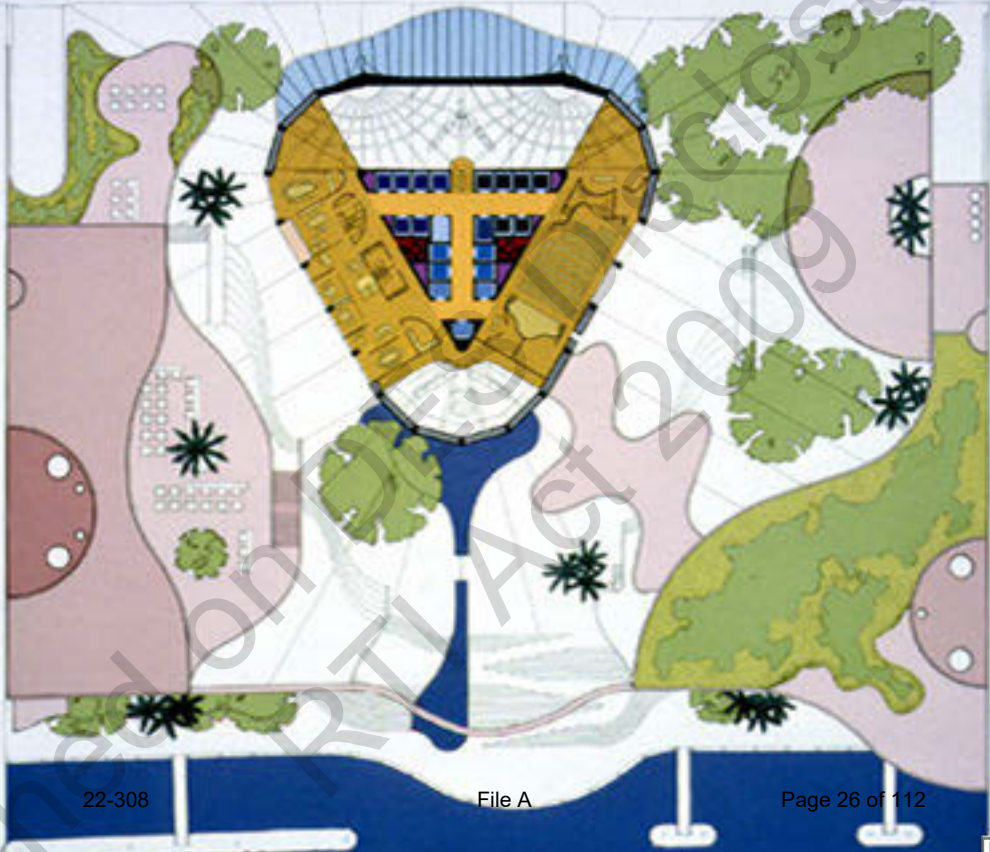

22-308

File A

Page 26 of 112

Release



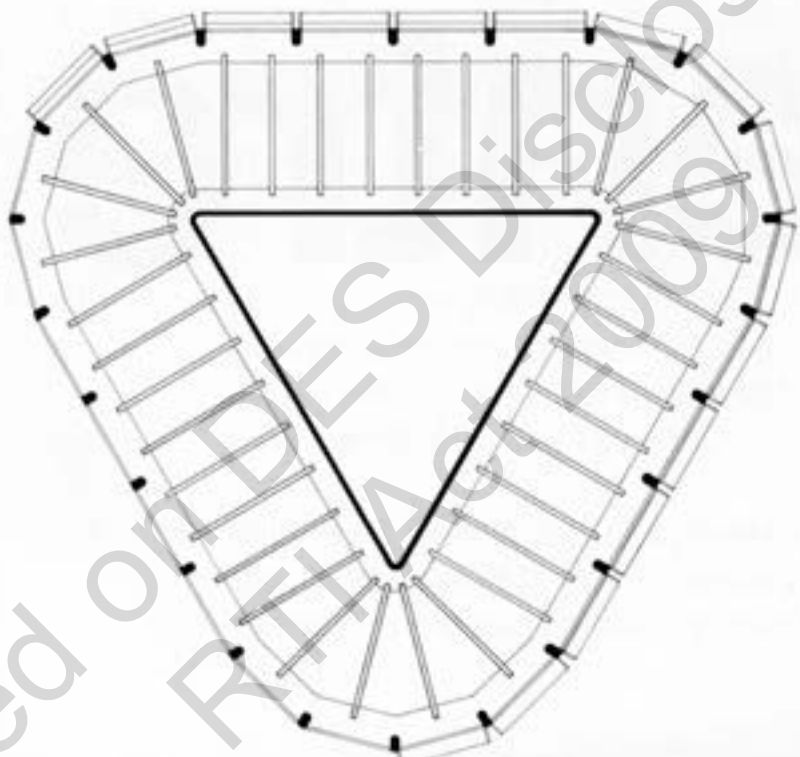



22-308

File A

Page 28 of 112

Relea

RECEIVE
REPLY
RECEIVE

22-308

File A

Page 29 of 112

Release





MICHAEL'S











22-308

Page 36 of 1

Release







RECYCLE
PLEASE RECYCLE
YOUR WASTE
PLEASE RECYCLE
YOUR WASTE



sch4p4(6) P





5-6

5-6



22-308

File A

Page 46 of 112

Release

















22-308

File A

Page 54 of 112

Release



sch4p4(





22-308

File A

Page 57 of 112

Release



22-308

File A

Page 58 of 112

Release



at
Riverside Eatery





at
Riverside Eatery



22-308

File A

Page 62 of 112

Releas









sch4p4(6) Personal information

sch4p4(6) Pe







22-308

Page A

Page 20

Released

Memorandum

Enquiries Marina Price
Telephone (07) 3227 6532
Your reference
Our reference 602401 BNE14736

5 February 2003

To: Greg Ouglitchinin
Executive Officer (Administrative Law)

Through: Olwyn Crimp
Director, Environmental Planning

From: Stewart Armstrong
A/g Manager, Qld Heritage Council Secretariat

Subject: **FOI Request 03/0007 – Riverside Centre, Brisbane**

I refer to your request of 22 January 2003 for an urgent search of our records to be carried out for any files or miscellaneous papers etc. relevant to the above request.

Attached are relevant documentation and files in relation to this request.

Stewart Armstrong
A/g Manager, Qld Heritage Council Secretariat

Enquires Joanne Ketter Site Registrar Queensland Heritage Council Secretariat
Telephone (07) 3227 8542
Your reference
Our reference 602401

19 December 2002

Ms Jude Munro
Chief Executive Officer
Brisbane City Council
GPO Box 1434
BRISBANE QLD 4001

Dear Ms Munro

Re: Application under s.24 of the Queensland Heritage Act 1992 proposing the entry in the Heritage Register of the Riverside Centre, Eagle Street, Brisbane.

I would advise that the Queensland Heritage Council has received an application for the **Riverside Centre, Eagle Street, Brisbane** described as:

Lot	Registered Plan	Parish	County
30	RP204762	NORTH BRISBANE	STANLEY

To assist the Queensland Heritage Council in the consideration of the application, I would be most grateful if you could please advise if:

- there is a valid Development and/or Building Approval for the place; or,
- there is a Development and/or Building Application currently before your Council for this place; or,
- any discussions are taking place concerning the future development of this place.

Furthermore, the Queensland Heritage Council would be pleased to receive any comments your Council may wish to make in relation to this proposal.

To allow this matter to be progressed I would be grateful if you could respond within 28 days of receipt of this letter.

If you would like to discuss the nomination further, please contact, Ms Robyn Hesse, Planning Manager, Planning Division, Southern Region on telephone (07) 3224 6233.

Yours sincerely

Ken Horrigan
Manager
Queensland Heritage Council Secretariat

c/c Ms Linda Bradby, Manager, Planning Division, Environmental Protection Agency, Southern Region (Jetset Building)

Enquires Joanne Ketter
Telephone (07) 3227 8542
Your reference
Our reference 602401

19 December 2002

The Executive Director
GPT Management Limited
C/- [sch4p4(6) Personal informa
PO Box 7121
RIVERSIDE CENTRE QLD 4001

Dear Sir or Madam:

Re: Application under s.24 of the Queensland Heritage Act 1992 proposing the entry in the Heritage Register of the Riverside Centre, Eagle Street, Brisbane.

I write to inform you that the Environmental Protection Agency has received a nomination to the Queensland Heritage Register for:

Riverside Centre, Eagle Street, Brisbane

The Agency understands that you own this property, which comprises:

Lot	Registered Plan	Parish	County
30	RP204762	NORTH BRISBANE	STANLEY

In writing to you, I am seeking some indication of your attitude toward the nomination. I hope also to avoid any misunderstanding concerning the Queensland Heritage Act 1992, should the Heritage Council proceed with entering the **Riverside Centre** in the Heritage Register. I enclose four pamphlets prepared by this Agency for owners of heritage places, which may answer some of your questions and possible concerns about heritage legislation.

If you would like to discuss the nomination further, please contact, Ms Robyn Hesse, Planning Manager, Planning Division, Southern Region can be contacted on telephone (07) 3224 6233.

Yours sincerely

Ken Horrigan
Manager
Queensland Heritage Council Secretariat

Enc. What is a Heritage Place?
What's in it for me? Advantages of owning a Heritage Property
Heritage Listing - What does it mean?
Heritage places - your questions answered

c/c Ms Linda Bradby, Manager, Planning Division, Environmental Protection Agency, Southern Region (Jetset Building)

AGENDA
QUEENSLAND HERITAGE COUNCIL MEETING NO. 187
FRIDAY, 2 DECEMBER 2005, COMMENCING AT 8.30AM
15th FLOOR, 160 ANN STREET, ENVIRONMENTAL PROTECTION AGENCY

Agenda No.	AGENDA ITEM	Page Number / Person reporting	Formal QHC resolution required
8.30am	In camera session		
9.00am	Meeting commences		
1.	APOLOGIES: John Adams		
2	MINUTES / ACTIONS OF PREVIOUS MEETING		
2.1	Minutes of Meeting No. 186 of 28 October 2005	P 1	Yes
2.3	Action list	P 19	For noting
3	BUSINESS ARISING FROM MINUTES:		
3.1	Strategic Directions Report	P 21	For noting
3.2	Strategic Directions <ul style="list-style-type: none"> • Goals and Actions 		
3.3	Monthly Meeting with Minister	DE verbal report	
3.4	Queensland Heritage Act 1992 Review	PH verbal report	
3.5	Statewide Assessment Project	FG verbal report	
3.6	Criteria for entering places in Heritage Register – Legal Advice	PH verbal report	
3.7	Heritage Places Financial Initiatives Committee	DE verbal report	
3.8	Land Valuations for Heritage Properties	DE verbal report	
10.15 am Morning Tea			
4	COPIES OF CORRESPONDENCE		
4.1	Incoming – for details see attached report (for declaration of interest see P 25)	P 25	Yes
4.2	Outgoing – for details see attached report	P 69	For Noting
5	RURAL HERITAGE PLACES COMMITTEE:		
5.1	Oral report from Chair		
5.2	Committee report	P 71	

AGENDA
QUEENSLAND HERITAGE COUNCIL MEETING NO. 187
FRIDAY, 2 DECEMBER 2005, COMMENCING AT 8.30AM
15th FLOOR, 160 ANN STREET, ENVIRONMENTAL PROTECTION AGENCY

6	HERITAGE REGISTER ADVISORY COMMITTEE:			
6.1	Oral report from Chair			
6.2	Minutes of Meeting No. No. 115 of 12 October 2005		P 73	Yes
6.3	Draft Minute Meeting No. 116 of 3 November 2005		P 80	For noting
10.30am Open Session commences				
7	HERITAGE REGISTER REPORTS			
7.1	NOMINATIONS (FOR INFORMATION ONLY): Eleven			
7.1.1	602566	s.73 Irrelevant information		For noting
7.1.2	602567			For noting
7.1.3	602568			For noting
7.1.4	602569			For noting
7.1.5	602570			For noting
7.1.6	602571			For noting
7.1.7	602572			For noting
7.1.8	602573			For noting
7.1.9	602574			For noting
7.1.10	602575			For noting
7.1.11	602576			For noting
7.2	NOMINATIONS FOR REVIEW: Nil			
7.3	HRAC RECOMMENDED FOR NOMINATION BY HERITAGE COUNCIL: Nil			
7.4	HRAC RECOMMENDED TO BE ENTERED BY HERITAGE COUNCIL: Four		See also separately attached photos	

AGENDA
QUEENSLAND HERITAGE COUNCIL MEETING NO. 187
FRIDAY, 2 DECEMBER 2005, COMMENCING AT 8.30AM
15th FLOOR, 160 ANN STREET, ENVIRONMENTAL PROTECTION AGENCY

7.4.1	602497	s.73 Irrelevant information	P 87	Yes
7.4.2	602536		P 97	Yes
7.4.3	602331		P 113	Yes
7.4.4	602190		P 124	Yes
7.5	HRAC RECOMMENDED NOT TO BE ENTERED:			
	Four			
7.5.1	602503	s.73 Irrelevant information	P 135	Yes
7.5.2	602545		P 142	Yes
7.5.3	602432		P 151	Yes
7.5.4	602543		P155 See also separately attached report incl.drawings	Yes
7.6	AMENDMENTS TO PERMENTANTLY ENTERED PLACES: Nil			
7.7	REVIEW OF PERMANENTLY ENTERED PLACES: Nil			
7.8	APPLICATIONS FOR REMOVAL FROM HERITAGE REGISTER RECEIVED: Nil			
7.9	PROPOSAL FOR REMOVAL FROM HERITAGE REGISTER: Nil			
11.15 am Open Session concludes				
7.10	OBJECTIONS TO PROVISIONAL ENTRY IN THE HERITAGE REGISTER: Nil (For information only)			
7.11	APPOINTMENT OF ASSESSORS: (For information only) Nil			
7.12	ASSESSOR'S REPORT RECEIVED FOR PERIOD: One			
7.12.1	s.73 Irrelevant information		P 184	Yes
7.13	OBJECTIONS TO PROPOSED REMOVAL FROM HERITAGE REGISTER: Nil			
7.14	APPEAL AND/OR REPORT PLANNING AND ENVIRONMENT COURT:			
7.14.1	Status Report of Appeals		P 318	For noting
7.14.2	s.73 Irrelevant information		P 322	Yes
7.14.3			KH verbal report	

AGENDA
QUEENSLAND HERITAGE COUNCIL MEETING NO. 187
FRIDAY, 2 DECEMBER 2005, COMMENCING AT 8.30AM
15th FLOOR, 160 ANN STREET, ENVIRONMENTAL PROTECTION AGENCY

7.14.4	601709	s.73 Irrelevant information	PH verbal report	
7.14.6	602000		PH verbal report	
7.14.7	600153 Brisbane		PH verbal report	
7.15	HERITAGE AGREEMENTS: Nil			
7.16	DEVELOPMENT AT HERITAGE REGISTERED PLACES:			
7.16.1	DEVELOPMENT COMMITTEE REPORTS:			
7.16.1.1	Oral report from Chair			
7.16.1.2	Minutes of Meeting No. 216 of 12 October 2005		P 344	Yes
7.16.1.3	Minutes of Meeting No. 217 of 2 November 2005		P 351	Yes
7.16.2	DEVELOPMENT APPLICATIONS: One			
7.16.2.1	s.73 Irrelevant information		P 359	Yes
7.16.3	EXEMPTION CERTIFICATES: Nil			
8.	GENERAL BUSINESS			
8.1	QHC Appointments		PH verbal report	
8.2	QHC Availability during Christmas Season		KH verbal report	
8.3	Media September / October		P 365	For noting
8.4	QHC Meeting Dates 2006 (For information)		P 404	For noting
8.5	QR – Memorandum of Understanding – for feedback		P 405	Yes
8.5.1	s.73 Irrelevant information		P 420	Yes
8.6	Heritage Decision Makers Guide to IPA – Project		FG verbal report	
8.7	Policy Matters:			

AGENDA
QUEENSLAND HERITAGE COUNCIL MEETING NO. 187
FRIDAY, 2 DECEMBER 2005, COMMENCING AT 8.30AM
15th FLOOR, 160 ANN STREET, ENVIRONMENTAL PROTECTION AGENCY

8.7.1	General Exemptions / Guidelines G2, G3, G4, G5	P 426 See also separately attached report P 429	Yes
8.7.2	s.73 Irrelevant information		Yes
8.8	Seminars and Workshops:		
8.8.1	ICOMOS Workshop 24/25 November 2005	CB verbal report back	
8.8.2	Australian and New Zealand Heritage Chairs submission to Productivity Commission	PH verbal report	

FOLLOWED BY:

- **WORKING LUNCHEON AT 1.00PM TO DISCUSS CURRENT HERITAGE ISSUES – VENUE:
FRIDAY'S, EAGLE STREET**
- **INCLUDES A POSSIBLE SITE INSPECTION OF RIVERSIDE CENTRE –**
- **NEXT MEETING TO BE HELD ON FRIDAY, 3 FEBRUARY 2006**

MEETING CLOSED:

File note of meeting/discussion

Meeting Telephone
Date: 5 Sept 2005 Time: 4.00pm
Between of Colliers (3370 1712)
And Stewart Armstrong of EPA
Subject: Riverside Centre

- is preparing a valuation for the building and was asking about the possible repercussions if the place is entered in the QHR.
- I explained that the process of entering the place in the QHR has started but then stalled so there was little information to go on.
- I explained that if the place was entered, based on other precedents, it was likely that the internal fitouts of the building would be largely unaffected, but the changes to the lobby area or the building façade would trigger applications.
- Similarly, fitouts to the lower side buildings would probably be able to continue but major changes to the exterior or additions or additional buildings would require some application process.
- said that the original concept included extra levels to the Pig and Whistle area and I explained that if that were proposed, it would not be precluded and if it was appropriately done, it could be approved.

Stewart



Fax

To: Mr Les Bevis **Fax:** (07) 3225 8495

From: Joanne Ketter
Site Registrar
Queensland Heritage Council Secretariat
Cultural Heritage Branch

Telephone: (07) 3227 8542 **Fax:** (07) 3227 7803

E-mail: Joanne.Ketter@epa.qld.gov.au

Date: 11 October 2004 **Pages:** 3 (including this page)

Subject: Riverside Centre, Brisbane

Hi Les

Please find correspondence attached regarding the Riverside Centre.

If you have any further questions regarding this matter please do not hesitate to call me on (07) 3227 8542.

Kind regards

sch4p4(6) Personal information

Joanne Ketter
Sites Registrar
Queensland Heritage Council Secretariat

Privacy and confidentiality notice

The information contained in this facsimile is intended for the named recipient/s only. It may contain privileged and confidential information and if you are not an intended recipient, you must not copy, distribute or take any action in reliance on it. If you have received this facsimile in error, please notify the sender.

③



JONES LANG
LASALLE

Jones Lang LaSalle (Qld) Pty Limited
ABN 40010411140
Level 7 Riverside Centre 123 Eagle Street Brisbane Qld 4000
PO Box 7121 Riverside Centre Brisbane Qld 4001
tel +617 38332366 fax +617 38332461

Ref:E.0201/B
6 October 2004

Mr Ken Horrigan
Manager, Queensland Heritage Council Secretariat
Environmental Protection Agency
Level 9, 160 Ann St
BRISBANE Q 4000



Dear Ken

Riverside Centre

Firstly, thanks for the opportunity to meet with yourself and Peta yesterday afternoon. Thanks also for explaining the process and likely timeframe in assessing the nomination of the Riverside Centre.

We reiterate our concern and that of our consultants, Allom Lovell, that the nomination of the Riverside Centre be appropriately evaluated in terms of the work of the architect, of post-1980's places generally in the Queensland Heritage Register, and of commercial office towers within the Brisbane CBD.

We also reaffirm our genuine concern regarding the proposal to seek Harry Seidler's opinion on the proposed listing, in light of recent legal issues between Seidler and the building owner on the matter of 'moral rights' and in particular the design of the Pig 'N' Whistle. We believe that this may adversely influence his opinion and only serve to complicate the issues at hand.

Ken, as you willingly acknowledged a commercial mixed use development of this magnitude (>50,000m²) is continually evolving with constant tenant changes, technological and environmental improvements and upgrades to plant, services and equipment. On the question of pending works we note that the following items were openly discussed:

- replacement of the existing revolving doors with automatic doors;
- reduction in size of the auditorium on level 6;
- relocation of toilet amenities on level 6;
- raising the height of the glass balustrades overlooking the lobby;
- construction of two new restaurants at boardwalk level;
- slab infill over the old and redundant ASX trading floor on level 5;
- façade changes on levels 5 & 6 to accommodate new 'sky gardens';

KT Bourgn
Noted

FWD: les

Benz

P.Y.I.

FWD: 11.10.04

- break-through with Riparian Plaza;
- ground floor coffee kiosk;
- extension of awning & decking at Pig 'N' Whistle.

We appreciate your frank advice that until such time as the Riverside Centre may be provisionally listed the Queensland Heritage Council and Environmental Protection Agency have no legal authority to approve or refuse any of the aforementioned works.

General Property Trust and Jones Lang LaSalle are however concerned that there is no suggestion of concealment in any of our dealings. We note that none of the proposed works seem to be of such magnitude as to warrant particular caution from yourself.

Notwithstanding we look forward to walking through with both Peta and Maureen next Thursday so that they can both see first hand what works we are proposing in the near future.

Ken, please be assured that General Property Trust and Jones Lang LaSalle fully recognise the special qualities and characteristics of the Riverside Centre and we will continue to maintain the building, plaza and surrounds to the highest standard.

Accordingly we look forward to working with you and the EPA to resolve the question of appropriate future care for the site.

Yours sincerely

sch4p4(6) Personal information

Asset Management Services

sch4p4(6) Personal information

General Manager, Riverside Centre

BNE 14736



Queensland Government

Enquires Michelle Sauter
Telephone 3225 8796
Email Michelle.Sauter@epa.qld.gov.au
Your reference
Our reference STH 602401

Environmental Protection Agency

Incorporating the
Queensland Parks and Wildlife Service

26 September 2003

sch4p4(6) Person

General Manager
Riverside Centre
Level 7 Riverside Centre
123 Eagle Street
BRISBANE Q 4000

Dear sch4p4(6) Pe

Riverside Centre

I refer to our previous discussions regarding the possible listing of the above on the Queensland Heritage Register, and acknowledge receipt of copies of the light and air easement agreements.

You will recall a heritage agreement was suggested as a possible basis for progressing a nomination. Could you please advise whether such a document has yet been drafted.

Please contact Ms Maureen Lillie on 3225 0146 if you have any queries.

Yours sincerely

sch4p4(6) Personal informati

sch4p4(6) Personal information

Robyn Hesse
Planning Manager, (SEQ)
Environmental Planning, Southern Region

Noted
2/10/03

C/c Manager, Queensland Heritage Council Secretariat, PO Box 155 Brisbane Albert Street QLD 4002

H:\PLANNING\SEQ Local Gov\Brisbane\2003\Heritage Act\General Enquiries\Riverside letter.doc

288 Edward Street Brisbane QLD
Queensland 4001 Australia
PO Box 2771 Brisbane QLD
Queensland 4002 Australia
Telephone (07) 3225 8560
Facsimile (07) 3225 8723
Website www.env.qld.gov.au
ABN 87 221 158 786

TRANSMISSION REPORT

BNE 14736
607401

D : CULTURAL HERITAGE

**Number L1 : 61732277803
Number L2 : 61732277803**

Date : 21-03-03 09:37

Date/Time	21-03 9:36
Dialled number	032383514
Subscriber	32383514
Durat.	0'59"
Mode	NORMAL
Pages	2
On	Line 2
Status	Correct

Fax



Queensland Government
Environmental Protection Agency
Incorporating the
Queensland Parks and Wildlife Service

To: Robyn Hesse, Planning Manager **Fax:** 3238 3514

From: Ken Horrigan
Manager Queensland Heritage Council Secretariat
Cultural Heritage Branch

Telephone: (07) 3227 8988 **Fax:** (07) 3227 7803

E-mail: Ken.Horrigan@epa.qld.gov.au

Date: 21 March 2003 **Pages:** 2 (including this page)

Subject: Riverside centre

Robyn

Further to our conversation this morning, I attach a fax from Frechills seeking a meeting with the Environmental Protection Agency to discuss the possible entry of the Riverside Centre in the Heritage Register.

I have not received any calls from Frechills regarding this matter, but I note that they advise they have left messages. I have returned sch4p call but he wasn't available.

I understand that Maureen Lillie is preparing an entry for this place.

Regards

Ken

Privacy and confidentiality notice
The information contained in this facsimile is intended for the named recipient/s only. It may contain privileged and confidential information and if you are not an intended recipient, you must not copy, distribute or take any action in reliance on it. If you have received this facsimile in error, please notify the sender.
PJ Box 155, Brisbane Albert Street, Queensland 4002, Australia

Fax



Queensland Government

Environmental Protection Agency

Incorporating the
Queensland Parks and Wildlife Service

To: Robyn Hesse, Planning Manager **Fax:** 3238 3514

From: Ken Horrigan
Manager Queensland Heritage Council Secretariat
Cultural Heritage Branch

Telephone: (07) 3227 8988 **Fax:** (07) 3227 7803

E-mail: Ken.Horrigan@epa.qld.gov.au

Date: 21 March 2003 **Pages:** 2 (including this page)

Subject: Riverside centre

Robyn

Further to our conversation this morning, I attach a fax from Freehills seeking a meeting with the Environmental Protection Agency to discuss the possible entry of the Riverside Centre in the Heritage Register.

I have not received any calls from Freehills regarding this matter, but I note that they advise they have left messages. I have returned sch4p4(6) P's call but he wasn't available.

I understand that Maureen Lillie is preparing an entry for this place.

Regards

Ken

Privacy and confidentiality notice

The information contained in this facsimile is intended for the named recipient/s only. It may contain privileged and confidential information and if you are not an intended recipient, you must not copy, distribute or take any action in reliance on it. If you have received this facsimile in error, please notify the sender.

Freehills

This facsimile is confidential. If you are not the intended recipient, you must not disclose or use the information contained in it. If you have received this facsimile in error, please tell us immediately (reverse charges).

Central Plaza I, 345 Queen Street, Telephone 61 7 3258 6666 (switch)
Brisbane QLD 4000 Australia 61 7 3258 6672 (fax operator)
DX 255 Brisbane Facsimile 61 7 3258 6444

Liability limited by the Solicitors' Limitation of Liability Scheme, approved under the Professional Standards Act 1994 (NSW)

From [Redacted] sch4p4(6) Personal inform
Phone (07) 3258 6674
Mobile [Redacted] sch4p4(6) Personal ir
Email [Redacted] sch4p4(6) Personal inf@freehills.com

To Ken Horrigan
 Manager
 Queensland Heritage Council
 Secretariat
 Fax (07) 3227 7803

Pages 1

*21/3/03
Returned calls
left message*

[Redacted] sch4p4(6) Personal informa

20 March 2003

Our ref Christopher Blue
 Matter no 80441045
 Doc no Brisbane003819561

Dear Sir

Riverside Centre, Eagle Street, Brisbane – Application for Heritage Listing

We refer to our facsimile dated 4 February 2003. Since sending our facsimile, we have left messages on two occasions with the Environmental Protection Agency attempting to arrange a meeting to discuss the proposal to nominate the Riverside Centre for heritage listing. To date we have not heard from you.

Our client is concerned about this matter and we again request that you meet with us to discuss the proposal.

Please let us know, as soon as possible, some suggested dates and times when you will be able to meet with us and our client's representatives. Would you please provide us with as much notice as possible of your suggested dates for the meeting as our client's representatives are based in Sydney.

We look forward to hearing from you.

Yours faithfully
Freehills
 [Redacted] sch4p4(6) Personal information
 Partner

Marina Price

From: Ken Horrigan
Sent: Thursday, 30 January 2003 7:32 PM
To: Marina Price
Subject: RE: FOI Riverside Centre

I have no information on this

Ken

-----Original Message-----

From: Marina Price [mailto:marina.price@epa.qld.gov.au]
Sent: Thursday, 30 January 2003 6:38 PM
To: Bronwyn Price; Cameron Harvey; Fiona Gardiner; Helen Bennett; Howard Pearce; Joanne Ketter; Julie Jones; Karen Murphy; Ken Horrigan; Malcolm Connolly; Margaret Lawrence-Drew; Meghan Bullen; Melanie Joannides; Mike Rowland; Natalie Franklin; Peta Dennis; Peter Hutchison; Stewart Armstrong
Subject: FOI Riverside Centre
Importance: High

Hello

I am compiling information for a FOI request for the Riverside Centre. Can you please advise me whether you have any documents in your possession, electronic or hardcopy which should be included in my compilation and are not already on the CH files. Can you please advise me by Tuesday, 4 February 2003. Thanks. Marina

Marina Price
Cultural Heritage Branch
Environmental Protection Agency
Tel:(07) 3227 6532
Fax:(07) 3227 7803

website: www.epa.qld.gov.au

Published on DES Disclosure Log
RTI Act 2009

00027

Marina Price

From: Stewart Armstrong
Sent: Monday, 3 February 2003 7:57 AM
To: Marina Price
Subject: RE: FOI Riverside Centre

Marina
I don't have any.
Stewart

-----Original Message-----

From: Marina Price [mailto:marina.price@epa.qld.gov.au]
Sent: Thursday, 30 January 2003 6:38 PM
To: Bronwyn Price; Cameron Harvey; Fiona Gardiner; Helen Bennett; Howard Pearce; Joanne Ketter; Julie Jones; Karen Murphy; Ken Horrigan; Malcolm Connolly; Margaret Lawrence-Drew; Meghan Bullen; Melanie Joannides; Mike Rowland; Natalie Franklin; Peta Dennis; Peter Hutchison; Stewart Armstrong
Subject: FOI Riverside Centre
Importance: High

Hello

I am compiling information for a FOI request for the Riverside Centre. Can you please advise me whether you have any documents in your possession, electronic or hardcopy which should be included in my compilation and are not already on the CH files. Can you please advise me by Tuesday, 4 February 2003. Thanks. Marina

Marina Price
Cultural Heritage Branch
Environmental Protection Agency
Tel:(07) 3227 6532
Fax:(07) 3227 7803

website: www.epa.qld.gov.au

00026

Marina Price

From: Joanne Ketter
Sent: Friday, 31 January 2003 3:39 PM
To: Marina Price
Subject: RE: FOI Riverside Centre

Hi Marina

I don't have anything.

cheers
Jo

-----Original Message-----

From: Marina Price [mailto:marina.price@epa.qld.gov.au]

Sent: Thursday, 30 January 2003 6:38 PM

To: Bronwyn Price; Cameron Harvey; Fiona Gardiner; Helen Bennett; Howard Pearce; Joanne Ketter; Julie Jones; Karen Murphy; Ken Horrigan; Malcolm Connolly; Margaret Lawrence-Drew; Meghan Bullen; Melanie Joannides; Mike Rowland; Natalie Franklin; Peta Dennis; Peter Hutchison; Stewart Armstrong

Subject: FOI Riverside Centre

Importance: High

Hello

I am compiling information for a FOI request for the Riverside Centre. Can you please advise me whether you have any documents in your possession, electronic or hardcopy which should be included in my compilation and are not already on the CH files. Can you please advise me by Tuesday, 4 February 2003. Thanks. Marina

Marina Price
Cultural Heritage Branch
Environmental Protection Agency
Tel:(07) 3227 6532
Fax:(07) 3227 7803

website: www.epa.qld.gov.au

00025

Marina Price

From: Ruth Woods [sch4p4(6)]@qut.edu.au
Sent: Monday, 3 February 2003 9:19 AM
To: Marina Price
Subject: Re: FOI Riverside

Marina
I do not have any documents.
Regards
Ruth Woods

At 01:12 AM 30/01/2003 +0000, you wrote:

>Dear All,
>I am compiling documents for a Freedom of Information request for the
>following place: Riverside Centre, 123 Eagle Street, Brisbane, described
>as Lot 30 on RP204762.

>
>The applicant is seeking copies of documents and correspondence in
>relation to the above place, in particular anything:

>
> * that relates to the architectural or cultural significance of
> improvements on the above place, and
> * items submitted by or on behalf of architect Harry Siedler or other
> architects,
> * applications for entry of the Riverside Centre in the Heritage
> Register, and
> * reports prepared for the Heritage Council or minutes of meeting
> considering the architectural or cultural significance of the Riverside
> Centre.

>Please note that the Branch has a copy of the Harry Seidler book,
>submitted by John Brannock and we have the documents submitted to HRAC and
>the Heritage Council, which were included in the HC agenda. Copies of
>your agenda papers not required as we already have these.

>
>What I am seeking from you is any additional documentation, you may have
>in relation to Riverside Centre as mentioned above, dated before the 20
>January 2003, .

>
>Can you please advise me whether you have any such documents, and if so I
>would need copies of these documents by cob Tuesday, 4 February 2003.

>
>Thanking you. Marina

>
>
>_____
>Marina Price
>Cultural Heritage Branch
>Environmental Protection Agency
>Tel: (07) 3227 6532
>Fax: (07) 3227 7803
>
>website: <<http://www.epa.qld.gov.au/>>www.epa.qld.gov.au
>

Regards
Ruth Woods FRAIA
Associate Director -Major Projects
Facilities Management QUT
ph 3864 3003 fax 3864 3625
email ra.woods@qut.edu.au
CRICOS No 00213J

Marina Price

From: John Adams [JAdams@ipswich.qld.gov.au]
Sent: Thursday, 30 January 2003 11:18 AM
To: marina.price@epa.qld.gov.au
Subject: Re: FOI Riverside

I have no additional documents.

>>> Marina Price <marina.price@epa.qld.gov.au> 30/01/2003 11:12:00 am
>>>

Dear All,

I am compiling documents for a Freedom of Information request for the following place: Riverside Centre, 123 Eagle Street, Brisbane, described as Lot 30 on RP204762.

The applicant is seeking copies of documents and correspondence in relation to the above place, in particular anything:

- 1.. that relates to the architectural or cultural significance of improvements on the above place, and
- 2.. items submitted by or on behalf of architect Harry Siedler or other architects,
- 3.. applications for entry of the Riverside Centre in the Heritage Register, and
- 4.. reports prepared for the Heritage Council or minutes of meeting considering the architectural or cultural significance of the Riverside Centre.

Please note that the Branch has a copy of the Harry Seidler book, submitted by John Brannock and we have the documents submitted to HRAC and the Heritage Council, which were included in the HC agenda. Copies of your agenda papers not required as we already have these.

What I am seeking from you is any additional documentation, you may have in relation to Riverside Centre as mentioned above, dated before the 20 January 2003, .

Can you please advise me whether you have any such documents, and if so I would need copies of these documents by cob Tuesday, 4 February 2003.

Thanking you. Marina

Marina Price
Cultural Heritage Branch
Environmental Protection Agency
Tel: (07) 3227 6532
Fax: (07) 3227 7803

website: www.epa.qld.gov.au

 This e-mail contains information that is intended for use only by the addressee. If you have received this e-mail in error, you are advised that copying, distributing, disclosing or otherwise acting in reliance on this e-mail is expressly prohibited. Please advise the original sender by REPLY email that you have received this email in error.

Thank you

00023

Marina Price

From: Catherine Brouwer
Sent: Friday, 31 January 2003 7:50 AM
To: Marina Price
Subject: Re: FOI Riverside
Importance: High

Marina
I don't have any
Catherine

4/2/03:

A verbal message has been ~~from~~ received from John Brannock's Assistant that no additional material is being held by him.

Published on DES Disclosure Log
RTI Act 2009

00022

Marina Price

From: Margaret Cook
Sent: Thursday, 30 January 2003 2:47 PM
To: Marina Price
Subject: RE: FOI Riverside

Dear Marina,

I have nothing to add to the pile of documents.

I can't believe the news about John Brannock. Thanks for letting us know.

Regards,

Margaret Cook

-----Original Message-----

From: Marina Price [mailto:marina.price@epa.qld.gov.au]
Sent: Thursday, 30 January 2003 11:12 AM
To: Adams John (E-mail); Brouwer Catherine (E-mail); Campbell Christine (E-mail); Chris Price (E-mail); john brannock (E-mail); John Brannock (E-mail); Margaret Cook (E-mail); Woods Ruth (E-mail)
Subject: FOI Riverside
Importance: High

Dear All,

I am compiling documents for a Freedom of Information request for the following place: Riverside Centre, 123 Eagle Street, Brisbane, described as Lot 30 on RP204762.

The applicant is seeking copies of documents and correspondence in relation to the above place, in particular anything:

1. that relates to the architectural or cultural significance of improvements on the above place, and
2. items submitted by or on behalf of architect Harry Siedler or other architects,
3. applications for entry of the Riverside Centre in the Heritage Register, and
4. reports prepared for the Heritage Council or minutes of meeting considering the architectural or cultural significance of the Riverside Centre.

Please note that the Branch has a copy of the Harry Seidler book, submitted by John Brannock and we have the documents submitted to HRAC and the Heritage Council, which were included in the HC agenda. Copies of your agenda papers not required as we already have these.

What I am seeking from you is any additional documentation, you may have in relation to Riverside Centre as mentioned above, dated before the 20 January 2003, .

Can you please advise me whether you have any such documents, and if so I would need copies of these documents by cob Tuesday, 4 February 2003.

Thanking you. Marina

Marina Price
 Cultural Heritage Branch
 Environmental Protection Agency
 Tel:(07) 3227 6532
 Fax:(07) 3227 7803

00021

Marina Price

From: Christine Campbell
Sent: Monday, 3 February 2003 3:58 PM
To: Marina Price
Subject: Re: FOI Riverside
 Marina

I do not have any additional documentation relevant to this FOI request

Christine
 Christine Campbell
 "Norwood" Blackall 4472
 Ph: 07-46574196 Fx 07-46574181
 Mob: [sch4p4(6) Person]
 Email: [sch4p4(6) Person]@b190.aone.net.au
 Latrobe ABN 48 127 201 468

----- Original Message -----

From: Marina Price
To: Adams John (E-mail) ; Brouwer Catherine (E-mail) ; Campbell Christine (E-mail) ; Chris Price (E-mail) ; john brannock (E-mail) ; John Brannock (E-mail) ; Margaret Cook (E-mail) ; Woods Ruth (E-mail)
Sent: Thursday, January 30, 2003 11:12 AM
Subject: FOI Riverside

Dear All,

I am compiling documents for a Freedom of Information request for the following place: Riverside Centre, 123 Eagle Street, Brisbane, described as Lot 30 on RP204762.

The applicant is seeking copies of documents and correspondence in relation to the above place, in particular anything:

1. that relates to the architectural or cultural significance of improvements on the above place, and
2. items submitted by or on behalf of architect Harry Siedler or other architects,
3. applications for entry of the Riverside Centre in the Heritage Register, and
4. reports prepared for the Heritage Council or minutes of meeting considering the architectural or cultural significance of the Riverside Centre.

Please note that the Branch has a copy of the Harry Seidler book, submitted by John Brannock and we have the documents submitted to HRAC and the Heritage Council, which were included in the agenda. Copies of your agenda papers not required as we already have these.

What I am seeking from you is any additional documentation, you may have in relation to Riverside Centre as mentioned above, dated before the 20 January 2003, .

Can you please advise me whether you have any such documents, and if so I would need copies of these documents by cob Tuesday, 4 February 2003.

Thanking you. Marina

Marina Price
 Cultural Heritage Branch
 Environmental Protection Agency
 Tel:(07) 3227 6532
 Fax:(07) 3227 7803

00020

Queensland Heritage Act 1992

Certificate of affect pursuant to Section 22 (1) (b).

(see reverse side of form)

Reference CA 17598

File Number 602401

Certificate issued under Section 22(1)(b) of the *Queensland Heritage Act 1992* (the "Act") as to whether a place is affected by an entry in the Heritage Register or is otherwise affected by the provisions of the Act.

This is to certify that the place described as,

[name of place]

Riverside Centre

and located at [address of place]

Eagle Street, BRISBANE

[real property description]

30/RP204762 Parish of SOUTH BRISBANE, County of STANLEY

in the local government area of [name of local government authority]

BRISBANE CITY COUNCIL

is subject to an application under Section 24(1) of the *Queensland Heritage Act* seeking the entry of the place in the Heritage Register;

sch4p4(6) Personal information

Date: 19 December 2002

For Chairperson, Heritage Council

Note: This certificate is valid at the date of issue only.

Fee received: \$25.00

Your reference: 80431508

Client Details:

Freehills
GPO Box 3124
BRISBANE QLD 4001



**Queensland
Government**
Environmental
Protection Agency

00019



Enquires Joanne Ketter Site Registrar Queensland Heritage Council Secretariat
Telephone (07) 3227 8542
Your reference
Our reference 602401

Environmental Protection Agency

Incorporating the
Queensland Parks and Wildlife Service

19 December 2002

Ms Jude Munro
Chief Executive Officer
Brisbane City Council
GPO Box 1434
BRISBANE QLD 4001

Dear Ms Munro

Re: Application under s.24 of the Queensland Heritage Act 1992 proposing the entry in the Heritage Register of the Riverside Centre, Eagle Street, Brisbane.

I would advise that the Queensland Heritage Council has received an application for the **Riverside Centre, Eagle Street, Brisbane** described as:

Lot	Registered Plan	Parish	County
30	RP204762	NORTH BRISBANE	STANLEY

To assist the Queensland Heritage Council in the consideration of the application, I would be most grateful if you could please advise if:

- there is a valid Development and/or Building Approval for the place; or,
- there is a Development and/or Building Application currently before your Council for this place; or,
- any discussions are taking place concerning the future development of this place.

Furthermore, the Queensland Heritage Council would be pleased to receive any comments your Council may wish to make in relation to this proposal.

To allow this matter to be progressed I would be grateful if you could respond within 28 days of receipt of this letter.

00017

If you would like to discuss the nomination further, please contact, Ms Robyn Hesse, Planning Manager, Planning Division, Southern Region on telephone (07) 3224 6233.

Yours sincerely

sch4p4(6) Personal information

Ken Horrigan
Manager
Queensland Heritage Council Secretariat

c/c Ms Linda Bradby, Manager, Planning Division, Environmental Protection Agency, Southern Region (Jetset Building)



Enquires Joanne Ketter
Telephone (07) 3227 8542
Your reference
Our reference 602401

Environmental Protection Agency

Incorporating the
Queensland Parks and Wildlife Service

19 December 2002

The Executive Director
GPT Management Limited
C/- Jones Lang Lasalle
PO Box 7121
RIVERSIDE CENTRE QLD 4001

Dear Sir or Madam:

Re: Application under s.24 of the Queensland Heritage Act 1992 proposing the entry in the Heritage Register of the Riverside Centre, Eagle Street, Brisbane.

I write to inform you that the Environmental Protection Agency has received a nomination to the Queensland Heritage Register for:

Riverside Centre, Eagle Street, Brisbane

The Agency understands that you own this property, which comprises:

Lot	Registered Plan	Parish	County
30	RP204762	NORTH BRISBANE	STANLEY

In writing to you, I am seeking some indication of your attitude toward the nomination. I hope also to avoid any misunderstanding concerning the Queensland Heritage Act 1992, should the Heritage Council proceed with entering the **Riverside Centre** in the Heritage Register. I enclose four pamphlets prepared by this Agency for owners of heritage places, which may answer some of your questions and possible concerns about heritage legislation.

00015

If you would like to discuss the nomination further, please contact, Ms Robyn Hesse, Planning Manager, Planning Division, Southern Region can be contacted on telephone (07) 3224 6233.

Yours sincerely

sch4p4(6) Personal information

Ken Horgan
Manager

Queensland Heritage Council Secretariat

Enc. What is a Heritage Place?

What's in it for me? Advantages of owning a Heritage Property

Heritage Listing - What does it mean?

Heritage places - your questions answered

c/c Ms Linda Bradby, Manager, Planning Division, Environmental Protection Agency, Southern Region (Jetset Building)

13 December 2002

Subject

RIVERSIDE CENTRE, EAGLE STREET, BRISBANE

(TBA)

Summary of Proposal

- Heritage Council is to consider on its own initiative to nominate the **Riverside Centre, Eagle Street, Brisbane**, to the Heritage Register under s.24 (1) of the *Queensland Heritage Act 1992*.

Date considered by Heritage Register Advisory Sub-committee: 05 December 2002

HRAC Recommendation:

That based on the oral report to the Heritage Register Advisory Committee, the **Riverside Centre, Eagle Street, Brisbane**, is a place of cultural heritage significance and meets one or more of the criteria under section 24 of the *Queensland Heritage Act 1992*, for entry in the Queensland Heritage Register.

Heritage Council Resolution

- Consider to nominate

Resolution 1

Having considered the oral report of the Agency for the **Riverside Centre, Eagle Street, Brisbane**, and the recommendation of the Heritage Register Advisory Committee for the **Riverside Centre, Eagle Street, Brisbane**, the Heritage Council resolves in accordance with Section 24(1) of the *Queensland Heritage Act 1992* to nominate the **Riverside Centre, Eagle Street, Brisbane** to the Heritage Register.

OR

- Not to nominate

Resolution 1

Having considered the oral report of the Agency for the **Riverside Centre, Eagle Street, Brisbane**, and the recommendation of the Heritage Register Advisory Committee for the **Riverside Centre, Eagle Street, Brisbane**, the Heritage Council resolves in accordance with Section 24(1) of the *Queensland Heritage Act 1992* **not** to nominate the **Riverside Centre, Eagle Street, Brisbane** to the Heritage Register.

Officer reporting

Joanne Ketter
Queensland Heritage Council Secretariat
06 December 2002

00015



CONFIRM

The answer you're looking for!

QVAS - Owner Name Search



Qvas
Menu



Main
Menu



Help

To perform a Title Search click on the link.

Property Address	RPD + Zoning Info	Owner/s Name	Owner/s Address
s.73 Irrelevant information			
123 EAGLE ST, BRISBANE CITY, 4000 Title Search	L30 RP204762:PAR NORTH BRISBANE 29 CENTRAL BUSINESS	GPT MANAGEMENT LIMITED	C/sch4p4 (6) Personal info PO BOX 7121, RIVERSIDE CENTRE, QLD 4001 AUSTRALIA

s.73 Irrelevant information

Published on DES Disclosure Log
RTI Act 2009

00012

s.73 Irrelevant information

24 results shown.

New Search

Refine Search

Generate Excel Sheet

[Download Microsoft Excel Viewer](#)

Results are ordered by locality, street name, and number, in ascending order.

Valuations Data reproduced with the permission of the State of
Queensland (Department of Natural Resources and Mines)

While every care is taken to ensure the accuracy of this data, the Department of Natural Resources and Mines makes no representations or warranties about its accuracy, reliability, completeness or suitability for any particular purpose and disclaims all responsibility and all liability (including without limitation, liability in negligence) for all expenses, losses, damages (including indirect or consequential damages) and costs which you might incur as a result of the data being inaccurate or incomplete in any way and for any reason.

Note: Zoning Information, within the Sales list, is based on information at the time of sale and is not necessarily the current zoning of the property.

© *The State OF Queensland (Department OF NATURAL Resources) [2002]*

CITEC CONFIRM

Queensland Valuation & Sales

NOT FOR resale - available ONLINE AT www.confirm.com.au

00011

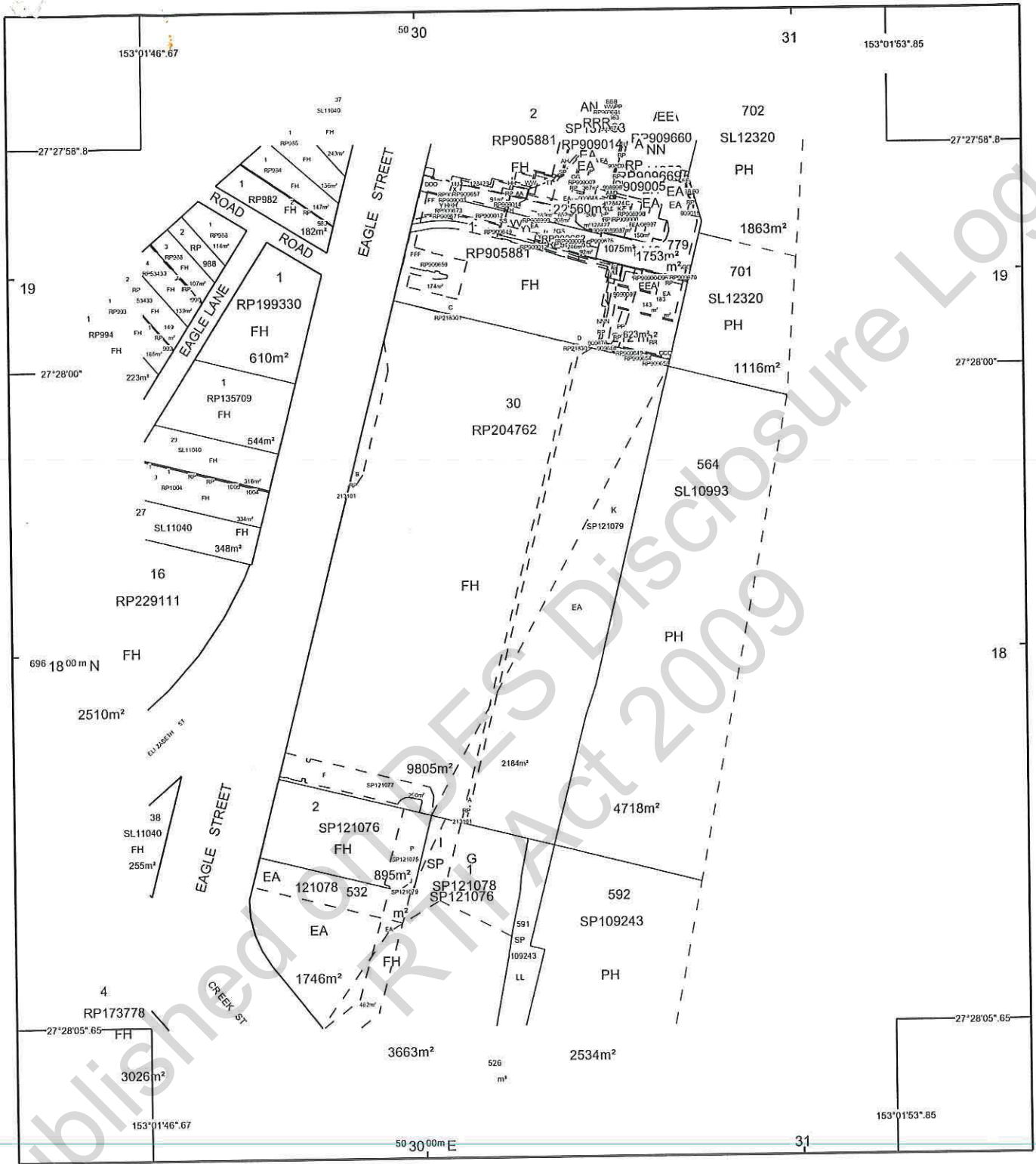

STANDARD MAP NUMBER
9543-33342

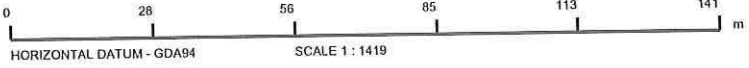

MAP WINDOW POSITION & NEAREST LOCALITY



SUBJECT PARCEL DESCRIPTION	
DCDB	No Lot/Plan Selected.
Lot/Plan	No Lot/Plan Selected.
Area/Volume	No Lot/Plan Selected.
Tenure	No Lot/Plan Selected.
Local Government	No Lot/Plan Selected.
Locality	No Lot/Plan Selected.
Parish	No Lot/Plan Selected.
County	No Lot/Plan Selected.
Parcel/Segment	No Lot/Plan Selected.

CLIENT SERVICE STANDARDS

PRINTED (dd/mm/yyyy) 4/12/2002
(Important Notice: The information hereon is NOT an OFFICIAL RECORD and its ACCURACY is NOT GUARANTEED)
DCDB 03/12/2002
For symbology see the BLIN Abbreviations Sheet.

LEGEND

SmartMap
An External Product of the Basic Land Information Network
Based upon an extraction from the Digital Cadastral Data Base

Queensland Government
Natural Resources and Mines
(c) The State of Queensland, Department of Natural Resources & Mines, 2002.

BLIN - Automated Titles System Enquiry (ATS)

Date Printed: 5/12/2002

Lot No: 30 Plan No: RP204762 Title Reference No: 17001194

TITLE DETAILS

Title Reference No: 17001194 Title Type Description: CT

Date Created (Freehold): 09/02/1987

Associated Lot\Plans: 30 RP204762

REGISTERED PROPRIETOR DETAILS

Dealing Number: 705136524

Tenancy Type: RE Tenancy Share: 1/1

Given Name:

Surname: GPT MANAGEMENT LIMITED

STATE LEASE DETAILS - No Details Found.

RESERVE DETAILS - No Details Found.

EASEMENT DETAILS

Dealing Number: 601290164

Dealing Type Code: 600 Dealing Type Description: EASEMENT

Endorsement Text: BURDENING THE LAND TO LOT 2 ON RP125128 OVER EASEMENTS C AND D ON RP218301

EASEMENT DETAILS

Dealing Number: 601361641

Dealing Type Code: 601 Dealing Type Description: EASEMENT IN GROSS

Endorsement Text: BURDENING THE LAND TO BRISBANE CITY COUNCIL OVER EASEMENT A ON RP213101

EASEMENT DETAILS

Dealing Number: 601361642

Dealing Type Code: 601 Dealing Type Description: EASEMENT IN GROSS

Endorsement Text: BURDENING THE LAND TO BRISBANE CITY COUNCIL OVER EASEMENT B ON RP213101

EASEMENT DETAILS

Dealing Number: 703419569

Dealing Type Code: 600 Dealing Type Description: EASEMENT

Endorsement Text: benefiting the land over EASEMENT P ON SP121075

EASEMENT DETAILS

Dealing Number: 703419614

Dealing Type Code: 600 Dealing Type Description: EASEMENT

Endorsement Text: burdening the land to LOT 2 ON SP121076 OVER EASEMENT F ON SP121077

EASEMENT DETAILS

Dealing Number: 703558960

Dealing Type Code: 600 Dealing Type Description: EASEMENT

Endorsement Text: benefiting the land over EASEMENT G ON SP121078

00009

EASEMENT DETAILS

Dealing Number: 703558961

Dealing Type Code: 600 **Dealing Type Description:** EASEMENT

Endorsement Text: benefiting the land over EASEMENT I ON SP121078

EASEMENT DETAILS

Dealing Number: 703558982

Dealing Type Code: 600 **Dealing Type Description:** EASEMENT

Endorsement Text: burdening the land to LOT 1 ON SP121076 OVER EASEMENT K ON SP121079

Important Note: The information hereon is NOT an OFFICIAL RECORD and its ACCURACY is NOT GUARANTEED nor does it constitute a TITLE SEARCH. For legal dealings, a Title Search (Statutory Product) must be obtained.

MINUTES
HERITAGE COUNCIL MEETING NO.142
8:30AM, FRIDAY, 13 DECEMBER 2002
LEVEL 15, 160 ANN STREET, BRISBANE

	The Heritage Council noted the new nominations.	
142.6.2	HRAC RECOMMENDED FOR NOMINATION BY HERITAGE COUNCIL:	
142.6.2.1	<p>Riverside Centre, Eagle Street, Brisbane</p> <p>A report prepared by the Agency, maps and a book entitled 'Riverside Centre' by Kenneth Frampton were tabled.</p> <p>MC noted that there are numerous other significant places nominated to the Heritage Register which are under threat and have been waiting to be researched for some time. HRAC's concern is that although the research for Riverside is scheduled to be undertaken as a priority it must also be completed thoroughly and comprehensively.</p> <p>JB said this place would lend itself ideally for the implementation of Heritage Agreement, which clearly identified the types of developments requiring and not requiring the lodgement of a s.34 development application.</p> <p>JA noted that this issue highlights the need for a standard Heritage Agreement form.</p> <p>QUEENSLAND HERITAGE COUNCIL RESOLUTION NO. 142.8 Having considered the report of the Agency for the Riverside Centre, Eagle Street, Brisbane, and the recommendation of the Heritage Register Advisory Committee for the Riverside Centre, Eagle Street, Brisbane, the Heritage Council resolved in accordance with Section 24(1) of the <i>Queensland Heritage Act 1992</i> to nominate the Riverside Centre, Eagle Street, Brisbane to the Heritage Register.</p> <p>MOVED: MC, SECONDED: JA, CARRIED: Unanimous</p>	
142.6.2.2	s.73 Irrelevant information	

13 December 2002

Subject

RIVERSIDE CENTRE, EAGLE STREET, BRISBANE

(TBA)

Summary of Proposal

- Heritage Council is to consider on its own initiative to nominate the **Riverside Centre, Eagle Street, Brisbane**, to the Heritage Register under s.24 (1) of the *Queensland Heritage Act 1992*.

Date considered by Heritage Register Advisory Sub-committee: 05 December 2002

HRAC Recommendation:

That based on the oral report to the Heritage Register Advisory Committee, the **Riverside Centre, Eagle Street, Brisbane**, is a place of cultural heritage significance and meets one or more of the criteria under section 24 of the *Queensland Heritage Act 1992*, for entry in the Queensland Heritage Register.

Heritage Council Resolution

- Consider to nominate

Resolution 1

Having considered the oral report of the Agency for the **Riverside Centre, Eagle Street, Brisbane**, and the recommendation of the Heritage Register Advisory Committee for the **Riverside Centre, Eagle Street, Brisbane**, the Heritage Council resolves in accordance with Section 24(1) of the *Queensland Heritage Act 1992* to nominate the **Riverside Centre, Eagle Street, Brisbane** to the Heritage Register.

OR

- Not to nominate

Resolution 1

Having considered the oral report of the Agency for the **Riverside Centre, Eagle Street, Brisbane**, and the recommendation of the Heritage Register Advisory Committee for the **Riverside Centre, Eagle Street, Brisbane**, the Heritage Council resolves in accordance with Section 24(1) of the *Queensland Heritage Act 1992* **not** to nominate the **Riverside Centre, Eagle Street, Brisbane** to the Heritage Register.

Officer reporting

Joanne Ketter

Queensland Heritage Council Secretariat

06 December 2002

Tabled at HC Meeting on 13/12/02

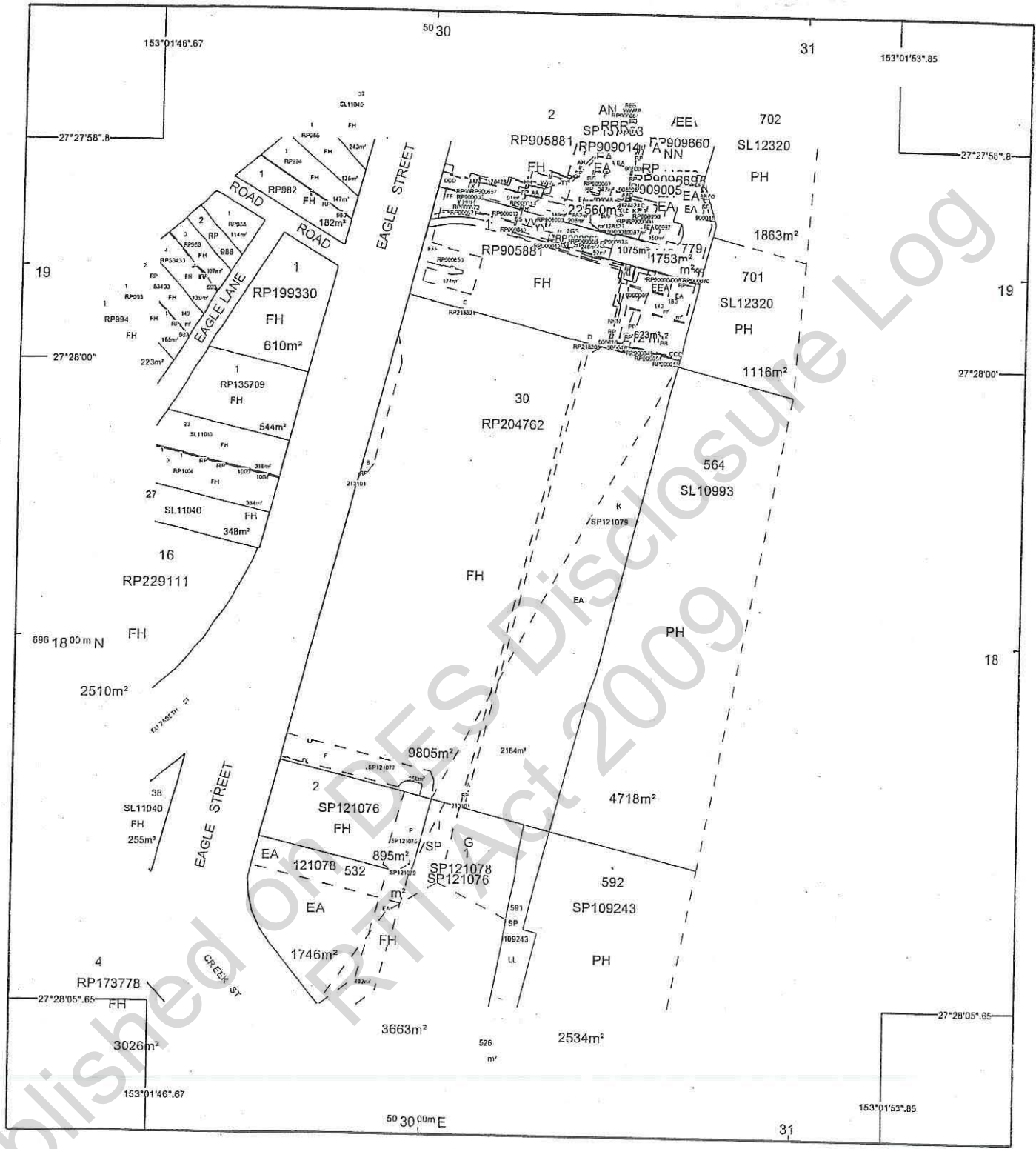

STANDARD MAP NUMBER
9543-33342

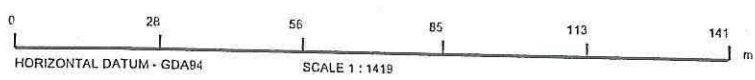

MAP WINDOW POSITION & NEAREST LOCALITY
153°01'50" 27°28'02" BRISBANE 0.18 KM

SUBJECT PARCEL DESCRIPTION

DCDB	
Lot/Plan	No Lot/Plan Selected.
Area/Volume	No Lot/Plan Selected.
Tenure	No Lot/Plan Selected.
Local Government	No Lot/Plan Selected.
Locality	No Lot/Plan Selected.
Parish	No Lot/Plan Selected.
County	No Lot/Plan Selected.
Parcel/Segment	No Lot/Plan Selected.

CLIENT SERVICE STANDARDS

PRINTED (dd/mm/yyyy) 4/12/2002
(Important Notice: The information hereon is NOT AN OFFICIAL RECORD and its ACCURACY is NOT GUARANTEED)
DCDB 03/12/2002
For symbology see the BLIN Abbreviations Sheet.

LEGEND

--

SmartMap

An External Product of the Basic Land Information Network. Based upon an extraction from the Digital Cadastral Data Base



Queensland Government
Natural Resources and Mines

(c) The State of Queensland, Department of Natural Resources & Mines, 2002

00005



BLIN - Automated Titles System Enquiry (ATS)

Date Printed: 5/12/2002

Lot No: 30 Plan No: RP204762 Title Reference No: 17001194

TITLE DETAILS

Title Reference No: 17001194 Title Type Description: CT

Date Created (Freehold): 09/02/1987

Associated Lot\Plans: 30 RP204762

REGISTERED PROPRIETOR DETAILS

Dealing Number: 705136524

Tenancy Type: RE Tenancy Share: 1/1

Given Name:

Surname: GPT MANAGEMENT LIMITED

STATE LEASE DETAILS - No Details Found.

RESERVE DETAILS - No Details Found.

EASEMENT DETAILS

Dealing Number: 601290164

Dealing Type Code: 600 Dealing Type Description: EASEMENT

Endorsement Text: BURDENING THE LAND TO LOT 2 ON RP125128 OVER EASEMENTS C AND D ON RP218301

EASEMENT DETAILS

Dealing Number: 601361641

Dealing Type Code: 601 Dealing Type Description: EASEMENT IN GROSS

Endorsement Text: BURDENING THE LAND TO BRISBANE CITY COUNCIL OVER EASEMENT A ON RP213101

EASEMENT DETAILS

Dealing Number: 601361642

Dealing Type Code: 601 Dealing Type Description: EASEMENT IN GROSS

Endorsement Text: BURDENING THE LAND TO BRISBANE CITY COUNCIL OVER EASEMENT B ON RP213101

EASEMENT DETAILS

Dealing Number: 703419569

Dealing Type Code: 600 Dealing Type Description: EASEMENT

Endorsement Text: benefiting the land over EASEMENT P ON SP121075

EASEMENT DETAILS

Dealing Number: 703419614

Dealing Type Code: 600 Dealing Type Description: EASEMENT

Endorsement Text: burdening the land to LOT 2 ON SP121076 OVER EASEMENT F ON SP121077

EASEMENT DETAILS

Dealing Number: 703558960

Dealing Type Code: 600 Dealing Type Description: EASEMENT

Endorsement Text: benefiting the land over EASEMENT G ON SP121078

00004

EASEMENT DETAILS

Dealing Number: 703558961

Dealing Type Code: 600 Dealing Type Description: EASEMENT

Endorsement Text: benefiting the land over EASEMENT I ON SP121078

EASEMENT DETAILS

Dealing Number: 703558982

Dealing Type Code: 600 Dealing Type Description: EASEMENT

Endorsement Text: burdening the land to LOT 1 ON SP121076 OVER EASEMENT K ON SP121079

Important Note: The information hereon is NOT an OFFICIAL RECORD and its ACCURACY is NOT GUARANTEED nor does it constitute a TITLE SEARCH. For legal dealings, a Title Search (Statutory Product) must be obtained.